AIRLINES

BOEING 757-200

MINIPACK



GENERAL INFORMATION

Airplane

MFR	Type/ Model	Customer Model	Registration Number	MFD	MSN	Line Number	Variable Number	Iden. Code
Boeing	757/ 757-200	757-22K		14/12/2000				

Engines

MFR	Model	ESN
Rolls Royce	RB211-535E4-37/16B	31427
Rolls Royce	RB211-535E4-37/16B	31758

APU

MFR	MODEL	P/N	ESN
Honeywell	GTCP 331-200 ER	3800298-1	P-2774

Weight Limitations

MSN	Taxi	Takeoff	Landing	Zero Fuel	Minimum Inflight Weight
25345	110.676	110.222	89.811	83.460	52.435

DETAILED INFORMATION

Airplane Last Heavy Maintenance		TSN	CSN	TSO	CSO
Date	14/DEC/2019	52205	12960		
Place	My Technic (Sabiha)				
Maintenance	1C+3C				

№1 Engine Last Shop Visit		TSN	CSN	TSO	CSO
S/N	31427	53533	13054	14958	3810
Date	07.01.2011				
Place	IBERIA				
Maintenance	Level 3				

№2 Engine Last Shop Visit		TSN	CSN	TSO	CSO
S/N	31758	52534	12915	18686	5150
Date	31.10.2012				
Place	IBERIA				
Maintenance	Level 3				

APU Last Shop Visit		TSN	CSN	TSO	CSO
S/N	P-2774	12453	14587	3220	2970
Date	04.12.2013				
Place	Air New Zealand Engineering Services				
Maintenance	2				

Avionics	
TCAS 7.1	p/n 822-1293-033
MMR	p/n 066-50029-1101
ATC (ADSB-OUT)	p/n 822-1338-003
FMC	p/n 4052506-955 (S242T102-455)
MCDU	p/n 4077880-908 (S242T102-161)
FCC	p/n 822-1261-102(S241T100-152)
EGPWC	p/n 965-0976-020-216-216
ELT (fixed)	p/n 453-5004
ADF (Type ADF-700)	p/n 622-5222-102
DME (Type DME-700)	p/n 622-4540-001
ADC	p/n 4040800-912 (S242T210-212)
EICAS	p/n 822-1033-100 (S242N701-1001)
SYMBOL GENERATOR	p/n 622-9436-100

-NOTICE-

THE INFORMATION CONTAINED HEREIN IS PROPRIETARY TO THE BOEING COMPANY AND SHALL NOT BE REPRODUCED OR DISCLOSED IN WHOLE OR IN PART OR USED FOR ANY PURPOSE EXCEPT WHEN SUCH USER POSSESSES DIRECT, WRITTEN AUTHORIZATION FROM THE BOEING COMPANY.

REV.	DESCRIPTION	DATE	APPROVED
G	REVISED "D" DIMENSION FOR B/C SEATS.		

DRWN: L.J. HARRIS
11/03/00
CHWD: L.J. HARRIS
11/03/00
APVD: P. NCPON
11/03/00

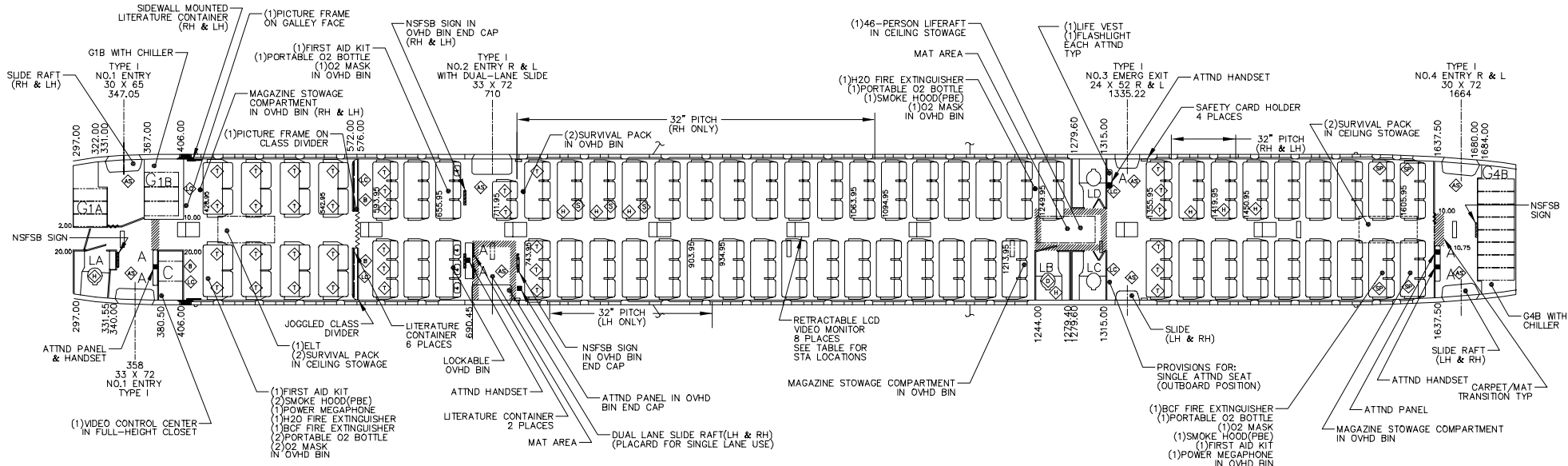

16 BUSINESS CLASS - 38 IN. PITCH

189 TOTAL PASSENGERS

173 TOURIST CLASS - 31/32 IN. PITCH

PLAN VIEW

FWD

NOTES:

* SEAT STATIONS ARE CALLED OUT TO THE CENTERLINE OF THE FWD SEAT STUD IN LOCKED POSITION.

THIS SEATING CONFIGURATION IS BASED ON THE INFORMATION IN THE SEAT GEOMETRY TABLE. ANY DEVIATION FROM THIS SEAT GEOMETRY MAY RESULT IN A CONFIGURATION CHANGE.

THIS DRAWING IS FOR REFERENCE ONLY AND IS NOT TO BE USED FOR FABRICATION, ASSEMBLY, INSTALLATION OR INSPECTION INFORMATION.

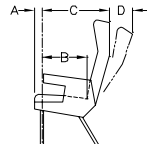

* STA XXX.95

GALLEY	VOLUME IN CUBIC FEET	---	163.2	182.0	345.2
APPROX. VOLUME					
G1A 74.9	VOLUME/PASSENGER IN CUBIC FEET	---	10.2	1.1	1.8
G1B 88.3	CART QUANTITY	---	6.0	8.0	14.0
G4B 182.0	CART SIZE	---	---	---	---
	COUNT	---	16	173	189
	PITCH	---	38"	32"/31"	---
	PERCENT	---	---	---	---
	VENDOR	---	WEBER	WEBER	---
	MODEL	---	7070	5300	---
SEAT					
S					
ITEM	FIRST CLASS	BUSINESS CLASS	TOURIST CLASS	TOTAL	

SEAT GEOMETRY				
DIM	F/C	B/C	T/C	
A	---	3.90	2.00	
B	---	15.01	15.50	
C	---	25.30	22.50	
D	---	9.70	6.00	

FLOTATION DEVICE			
P=PROVISIONS		✓=BOEING INSTALLED	
PASSENGER SEAT	CUSHION	LIFE VEST IN/ UNDER SEAT	LIFE VEST IN P.S.U.
ATTENDANT SEAT		✓	

RETRACTABLE LCD VIDEO MONITOR LOCATIONS	
STA (VIEWING SURFACE)	
408	
588	
730	
872	
1008	
1128	
1332	
1468	

- PBE PROTECTIVE BREATHING EQUIPMENT.
- ELT EMERGENCY LOCATOR TRANSMITTER.
- ◇ LCD VIDEO MONITOR.
- ◇ STRETCHER PROVISIONS.
- ◇ BASSINET PROVISIONS.
- ◇ DIAPER TABLE.
- ◇ HANDICAPPED PASSENGER FEATURES.
- ◇ INTEGRAL IN-ARM FOOD TRAY.
- ◇ SPECIAL SEAT MAY BE REQUIRED TO MAINTAIN SIDEWALL CLEARANCE AND/OR MINIMUM F.A.A. AISLE REQUIREMENTS.
- ◇ ASSIST SPACE AND EXIT AISLE REQUIREMENTS MUST MEET F.A.A. GUIDELINES.
- Ⓟ DENOTES INCHES OF RECLINE SPACE AVAILABLE PER SEAT WHEN LIMITED FROM MAXIMUM.

NT446-NT450 BASELINE LOPS-5724-2624

AUTOCAD/CID FILE : 5742951G
CATIA DATA BASE : RPMLOPA
DATABASE : LOPS-5724-2951-G

FAA

757-22K

BOEING
CORPORATE OFFICES SEATTLE, WA. 98124

INTERIOR ARRANGEMENT (DELIVERY)
TURKMENISTAN AIRLINES (TUE)

FSM NO. 81205
DWG NO. LOPS-5724-2951